

INSTALLATION INSTRUCTIONS

Muffler Kit, Part No. 807752

This Muffler Kit can be used on both horizontal and vertical crankshaft engines Model Series 290000, 303000.

1. On ducted engines it is necessary to provide clearance for the exhaust manifold. Remove cylinder shield and cut away material as show in Fig. 1.

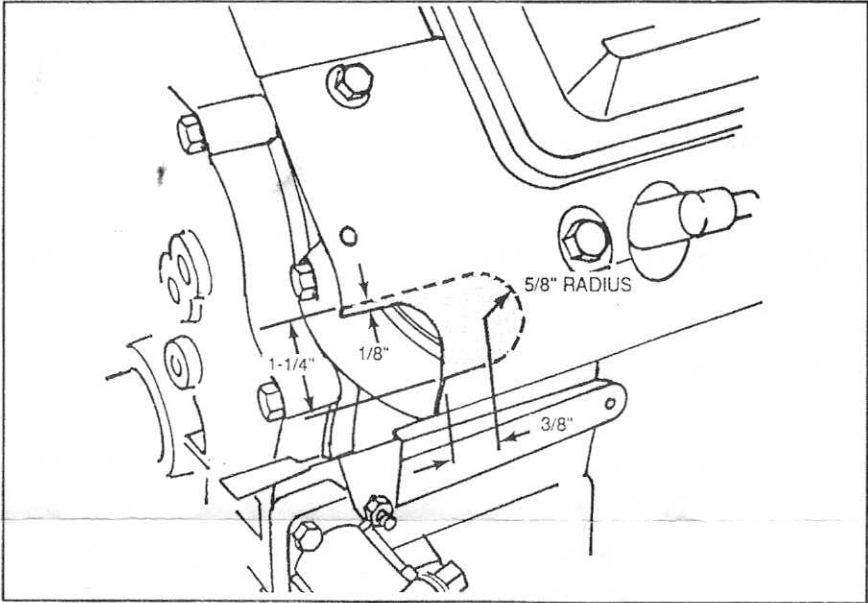

Fig. 1

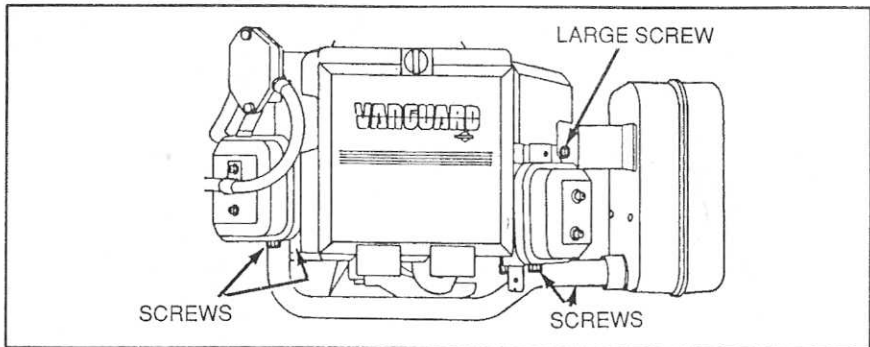

Fig. 2



BRIGGS & STRATTON CORPORATION
Milwaukee, Wisconsin 53201

2. Coat threads of exhaust manifold screws with Part #93963, Valve Lubricant. Install exhaust manifold, exhaust gaskets, and screws. Torque screws to 190 in. lbs., Fig. 2.
3. Coat zinc colored screws with Part #93963. Assemble muffler bracket to muffler with two screws. Hand tighten screws. Place remaining two screws in two remaining holes, Fig. 2.
4. Remove two screws from blower housing, Fig's 2 and 3. Discard smaller screw.
5. Place muffler clamp on muffler and slide muffler assembly on exhaust outlet. Reinstall large screw through mounting bracket and new small yellow dichromate screw through other hole and tighten screws.
6. Tighten screws holding muffler to bracket and then tighten muffler clamp.

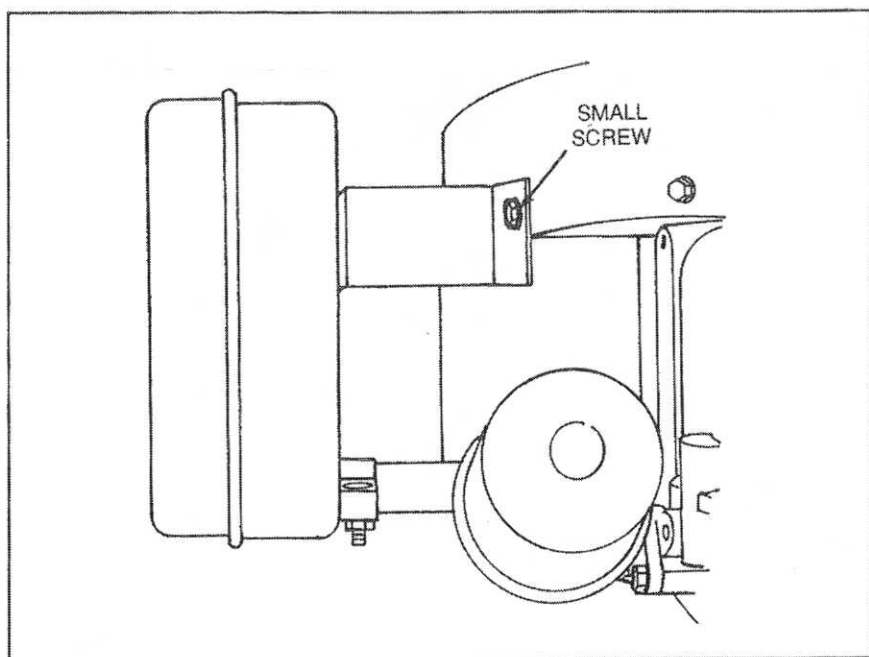

Fig. 3